

These particulars are believed to be accurate but they are not guaranteed and do not form a contract. Neither Jordan Fishwick nor the vendor or lessor accept any responsibility in respect of these particulars, which are not intended to be statements or representations of fact and any intending purchaser or lessee must satisfy himself by inspection or otherwise as to the correctness of each of the statements contained in these particulars. Any floorplans on this brochure are for illustrative purposes only and are not necessarily to scale.

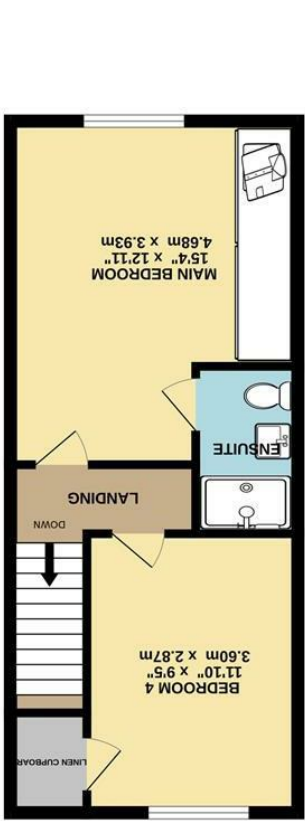

Measurements are approximate. Not to scale. Illustrative purposes only.
TOTAL FLOOR AREA : 1228 sq.ft. (114.0 sq.m.) approx.
Made with Metropix ©2024



2ND FLOOR
396 sq.ft. (36.8 sq.m.) approx.



1ST FLOOR
396 sq.ft. (36.8 sq.m.) approx.



GROUND FLOOR
435 sq.ft. (40.4 sq.m.) approx.





The Property

A stylish town house forming part of a popular purpose built development in West Didsbury with a driveway to the front and enclosed garden at the rear. 1228 sq ft. Warmed by gas fired central heating which is further complemented by uPVC double glazing, the tastefully presented living space is laid out over three floors with numerous noteworthy features including a a great sized through living area which includes an upgraded contemporary fitted kitchen with appliances, four double bedrooms, en-suite shower room, walk-out balcony, fitted wardrobes and a family bathroom with modern suite.

- Stylish townhouse
- Popular development in West Didsbury
- Four double bedrooms
- Main bathroom & En-suite
- Open plan living/kitchen area
- Walk-out balcony
- Fitted wardrobes
- Gas central heating
- uPVC double glazing
- Driveway & gardens



Directions

M20 2LU

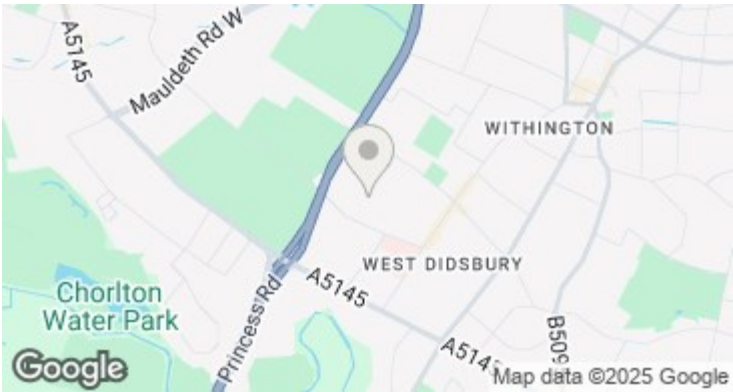

Postcode - M20 2LU

EPC Rating - C

Floor Area - 1228.00 sq ft

Local Authority - Manchester City Council

Council Tax - E

Highmarsh Crescent, West Didsbury M20 2LU

£430,000

